

PHILIPS

Professional Lighting

RoadGrace

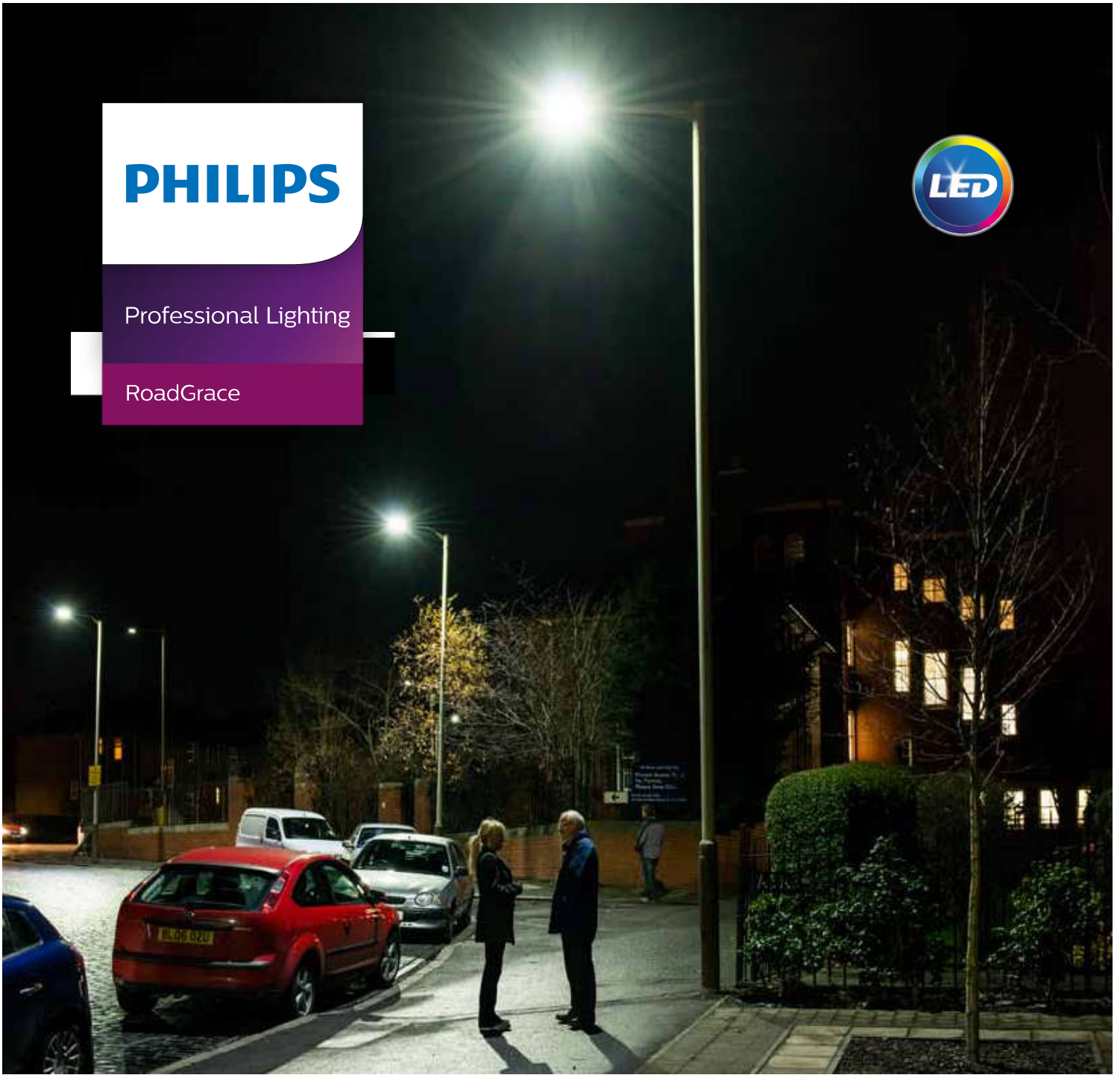

Enhance the city with
a new way of light

A new benchmark for LED roadway lighting



We now light up roads differently. It's no longer just about functionality as it is also about how road lighting can effortlessly complement new areas, and seamlessly retrofit into existing areas.

With the RoadGrace LED luminaire, you can upgrade to an energy efficiency solution, and amazing flexibility with its five optic options, optimized for multiple road and street applications, such as freeways, intersections and crosswalks.

Features & benefits:

- Designed to withstand extreme temperatures with superior thermal management (-40 to 50C Ta)
- Top-class LED that ensures reliability and a long 100,000-hour lifetime. Cities save on maintenance costs and safeguard the community's safety, sustainably.
- Easy to install, it has tool-less access and an adjustable mounting spigot design that enables customization of the lighting set-up to achieve the desired effect.
- Comes with five optic options, optimized for various road and street applications.

The road to brightness

Configurations

Supports CityTouch, 1-10V/DALI/Amp/Dynadimmer controls, and 7 Pin NEMA socket

Lumen Output up to

8,700lm for small housing

17,000lm for medium housing

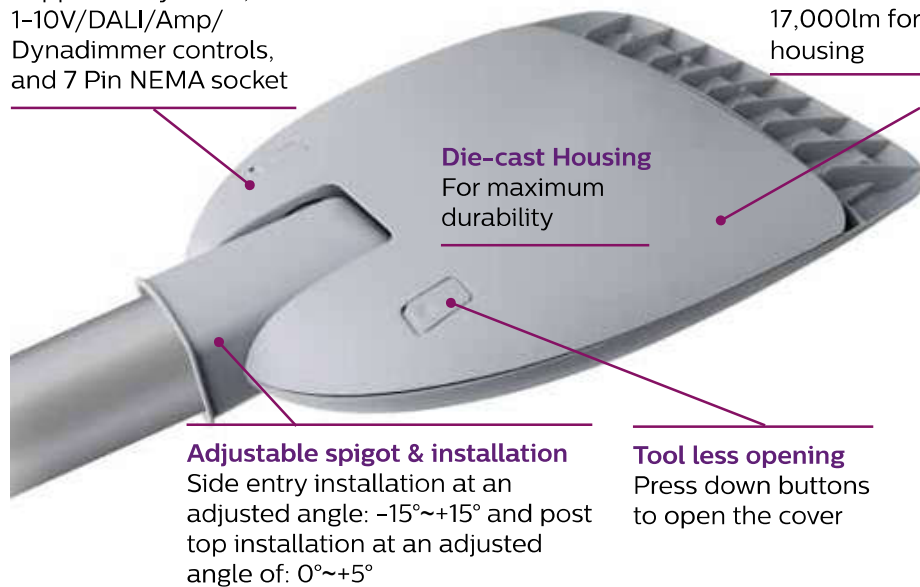

Die-cast Housing

For maximum durability

Adjustable spigot & installation

Side entry installation at an adjusted angle: $-15^{\circ} \sim +15^{\circ}$ and post top installation at an adjusted angle of: $0^{\circ} \sim +5^{\circ}$

Tool less opening

Press down buttons to open the cover

Applications

- Freeways
- Intersections
- Crosswalks

RoadGrace Configurations



On-off luminaire

Integrated with CTC

With PE cell

Support CityTouch, 1-10V/DALI/Amp/Dynadimmer controls and 7 Pin NEMA socket

Take the next step

See how Philips RoadGrace LED Luminaires can provide a complete solution for your roadway lighting needs. Contact your local Philips Sales Representative or visit for more information or to schedule a personalized demonstration.

Product data

General Characteristics

Model	RoadGrace
Electric class	Class I and Class II
Cover	Transparent and weather resistant grade Polycarbonate
Color consistency (SDCM)	SDCM 5 at Luminaire level

Technical Characteristics

System lumen output (lm)	Small Housing up to 8,700lm Medium Housing up to 17,000lm
Color temperature CCT	3,000K, 4,000K, 5,700K
CRI	Min 70 additional option of CRI 80
Housing material	High pressure die-cast aluminum (ADC1)
Optics	BRP711 - DM, DW1, DW2, DWP, DWP3 BRP712 - DM, DW1, DW2, DWP3
Service Lifetime	100,000 hours (L70 at Ta 35C)
TM21 Projection	100,000 hours L80 160,000 hours L70
Power factor	0.9
Ingress protection IP	IP66
Impact resistance IK	IK08
Working temperature	-40 to 50C
Input voltage	220V-240V 50/60Hz additional option of 120V-277V and 100V-277V (for Japan)
Working humidity	Up to 95%
Surge protection	15kV/kA
Control interface	CityTouch Ready, 1-10V/DALI/ Amp/Dynadimmer, 7-Pin NEMA

Product Information

Dimensions (LxWxH)	BRP711: 584 X 388 X 87 mm BRP712: 683 X 388 X 87 mm
Weight	BRP711: 6.8kg BRP712: 7.4kg
Mounting	Φ25-34mm pole; Side-Entry with Adjustable angles +/- 15 degrees Φ42-60mm pole; Side-Entry with Adjustable angles +/- 15 degrees Φ60-77mm pole; Post Top with Adjustable angles +/- 5 degrees
Certifications	CB IEC60598, AS/NZS60598, TS1158, PSE, CE, RoHS

Ordering Information

BRP711 LED25/NW 17W DM 42-60
BRP711 LED33/NW 23W DM 42-60
BRP711 LED49/NW 37W DM 42-60
BRP711 LED73/NW 55W DM 42-60
BRP711 LED96/NW 72W DM 42-60
BRP712 LED 120/NW 90W DM 42-60
BRP712 LED 145/NW 107W DM 42-60
BRP712 LED 167/NW 124W DM 42-60
BRP712 LED 190/NW 140W DM 42-60

More Options available

Description Abbreviations:

"ANZ" denotes TS1158 and Φ25-34mm side-entry spigot

