

A photograph of a historic building at night, illuminated by Philips Vaya Uplight HP in-ground lighting. The building features ornate architectural details, including arched windows and a balcony. The lighting is installed in the ground along the base of the building, casting a warm, golden glow that highlights the building's facade and creates a sense of depth and texture. The sky is dark, and the overall atmosphere is one of elegance and sophisticated lighting design.

PHILIPS

Decorative Lighting

Vaya Uplight HP



High-power radiance at its best

In-ground lighting draws attention to the overall beauty and intricate details of a building structure, and should also provide a sense of comfort and security. Vaya Uplight HP (High-power) delivers a unique level of brightness and visual allure that is perfect to highlight any edifice and its surroundings.

This high efficiency LED in-ground light is designed to put up an effortless lighting display. Vaya Uplight HP has a ultra-high lumen output that is perfect for night lighting, and easily outshines any traditional 70W metal halide lamp. Equipped with a bevy of optical configurations, it fulfills a wide range of lighting requirements with extreme versatility that caters to various environment applications. With a convenient adjustable angular design, Vaya Uplight HP provides facility owners and specifiers with the fastest and easiest lighting solution to achieve a myriad of illuminating effects on the spot with optimum radiance and excellent convenience. Its long lifetime also means reduced rate of replacement and hence lower maintenance costs apart from energy savings for the owner.



Benefits

- **Optimal light quality.** Ultra-high lumen output that outperforms any traditional metal halide lamp (up to 70W) upright.
- **Extreme versatility.** Multiple optical configurations cater to a variety of environment applications.
- **Optimum illuminating effects.** Convenient adjustable angular design provides on-the-spot convenience when adjusting to desired optical effect.
- **High grade of protection.** Top-notch safety against external pressure and impact and provides waterproof protection.
- **Long life.** Low-power LED lighting with long lifespan to provide significant cost savings.

Features

- Maximum lumen output of 3,400lm with 96lm/W light efficiency that makes a perfect substitute for up to 70W metal halide underground lamp.
- 3 beam angles for standard configuration, Option of anti-glare louver and decorative panels to meet various lighting requirements.
- Field adjustable design without the need to open the enclosure, with nuts that can be adjusted according to graduated disc, providing optimum effect range of between -15° ~ $+15^{\circ}$ to achieve the most suitable optical effects on the spot.
- High protection level (IP67, IK10 and 20KN static pressure) configured with a waterproof connecting plug.
- 50,000 hours lifetime.

Applications

- Square, garden, and courtyard
- Hotel and business quarters
- Decorative lighting for pedestrian malls
- Safety lighting for residential quarters



Dimensional drawing

Unit in mm

BBP 331 luminaire

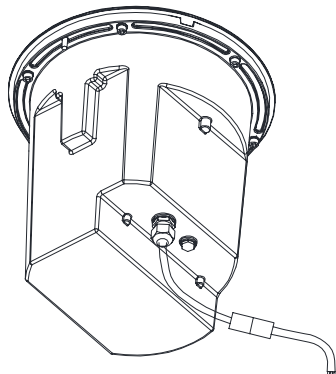
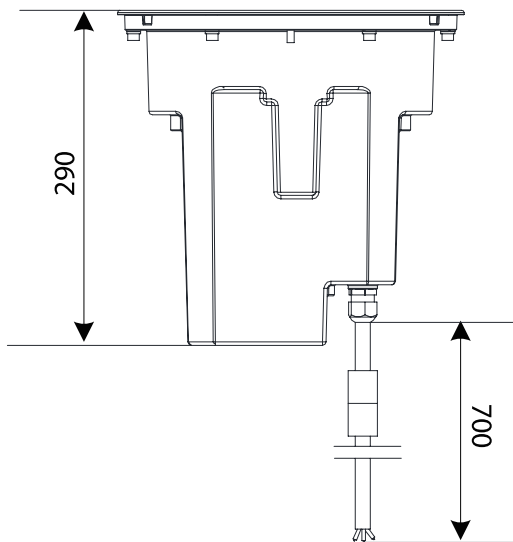

BBP331 embedded housing

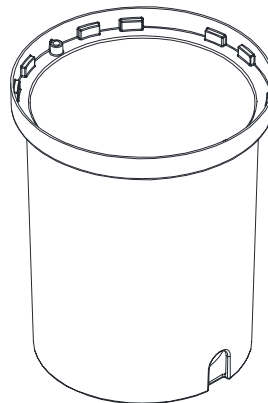
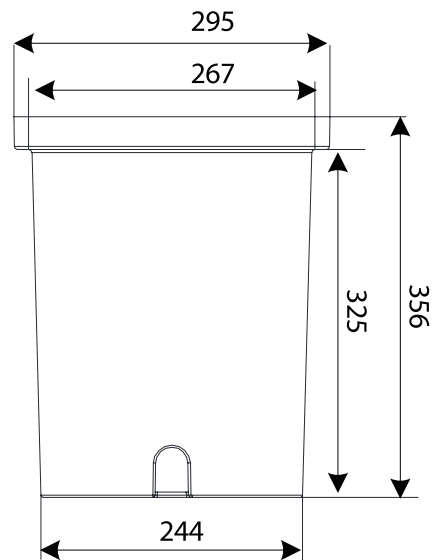

Product data

Product model	BBP331 15LED	BBP331 21LED
LED case	15pcs high power LED	21pcs high power LED
Color of light source	Warm white WW(3000K), natural white NW(4000K), green GN	Warm white WW(3000K), natural white NW(4000K)
Color consistency	SDCM=5	
Color rendering	CRI75	
Luminous flux	Warm white WW: >2200lm Natural white NW: >2400lm Green GN: >1200 lm	Warm white WW: >3100lm Natural white NW: >3400lm
Light efficiency	Warm white WW: 88lm/w Natural white NW: 96lm/W	
Beam angle	15°,25°,55°	
Optical configuration	Polarizing angle regulation:±15°, Option of anti-glare louver and decorative panel. (Note: 55° fitting c/w anti-glare louver and available on request for 15° and 25° fitting)	
Power consumption	25W	35W
Supply voltage	220-240VAC	
Control interface	ON/Off	
Installation method	Underground installation	
Material & process	Enclosure: die-casting aluminum, embedded housing: nylon+ glass fibre, luminous surface: tempered glass	
Lifetime	50,000 hours (70% lumen maintenance @ Ta = 35°C)	
Weight	8.0kg	
Product dimensions (diameter* height)	Lamp body Ø 300*290mm, embedded housing Ø 295*356mm	
Classification & Certification	Class I. IP67.IK10. static pressure20KN Operating temperature:-40°C-50°C CCC, CB, Rohs, CE	

