

LED Step-Light

Offers a reliable and safe solution to step lighting with its uniform asymmetrical lighting, easy installation with equipped mounting box.



Features and benefits

- High quality long lifetime LED light source and integrated electronic driver ensures a serviceable life of more than 25,000 hours.
- Proven IP67 compliance for exceptional water resistance throughout its lifetime.
- Comes with a mounting box for easy installation.
- Integrated driver makes installation simple.

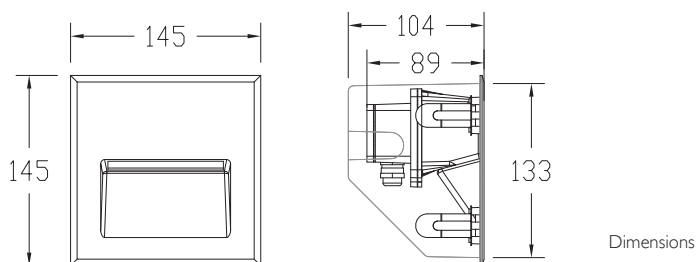

Type	BWG150
Light Source	36 x low power LEDs
Light Color	Warm white (3000K), Neutral white (4000K)
Lumens	WW: 35lm NW: 40lm
CRI	NW>75 WW>80
Optic	Closed, diffuser
Optic cover	Poly carbonate diffuser
System power	4W
Driver	220-240V / 50-60Hz, integrated (non-dimmable)
Electrical class	Class I
Degree of protection	IP67
Resistance to heat and fire	GWT=850°C for plastic parts
Main cabling	Via 1 x M16 cable gland accepting cable 3 core x 1.0mm ²
Connection	Push in connector in 3 poles accepting wires 3 core x 1.0mm ²
Material	Housing: Die cast aluminum; Diffuser: PC; Mounting box: Plastic
Color	Dark grey (RAL 7043), Light grey (RAL 9006)
Operating temperature	-20°C < Ta < 40°C
Lifetime	25,000 hours 70% lumen maintenance @ Ta=25°C
Installation	Wall recessed mounting
Weight	0.55 Kg
Dimensions (mm)	L145 x W145 x D104
Test House-marks	CCC, CE and RoHS compliance